



HESTORE.HU

elektronikai alkatrész áruház

EN: This Datasheet is presented by the manufacturer.

Please visit our website for pricing and availability at www.hestore.hu.



Wah Wang Data Sheet For 1206 Blue SMD

Part No: WW-BIS150TS-E



Address : Unit 01, 19th Floor, Nanyang Plaza,
No.57 Hung To Road, Kwun Tong,
Kowloon, Hong Kong
Tel : 852-2512 9939 (10 line)
Fax : 852-2344 2398
Web Site : www.wahwang.com

S.D.N. or D.N. No. : _____

Customer Name : _____

Sample Approval Signature : _____

Date : _____



Features

- 1. Chip LED.
- 2. SMD LED dimensions: 3.2(L) x 1.6(W) x 0.7(H) mm
- 3. High intensity
- 4. Extremely wide view angle
- 5. Anti-electrostatic tape package
- 6. Reliable and stable

Part No.	WW-BIS150TS-E
Lens Color	Water Clear
Emitting Color	Blue
Resin (mold)	Epoxy

Package Dimension

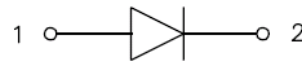
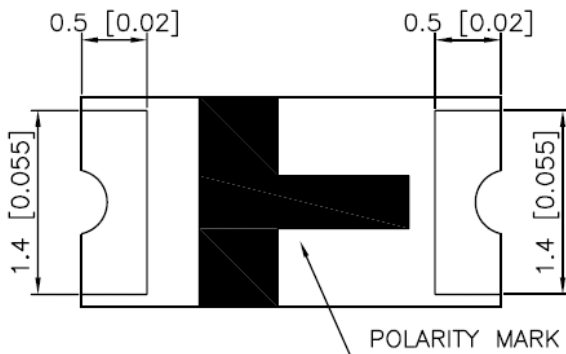
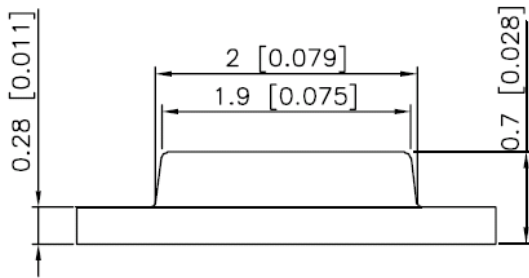
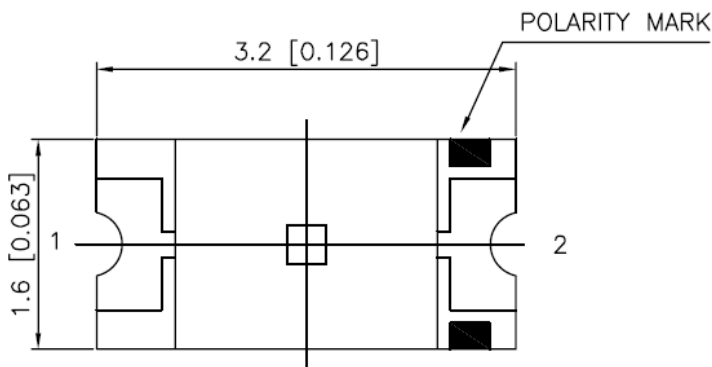



Absolute Maximum Ratings at Ta=25



◆ Typical Electrical/Optical Characteristics Curves

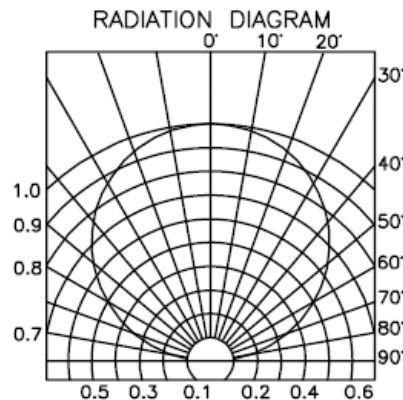
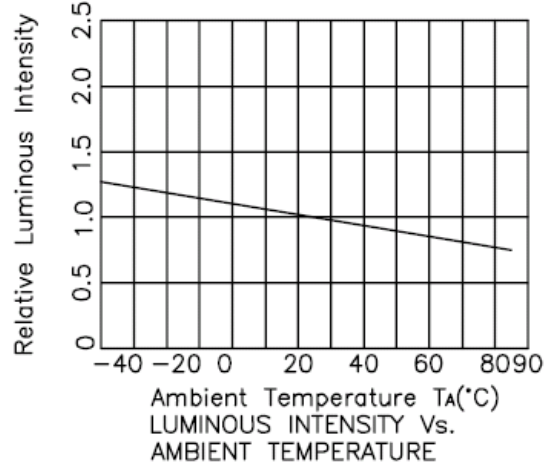
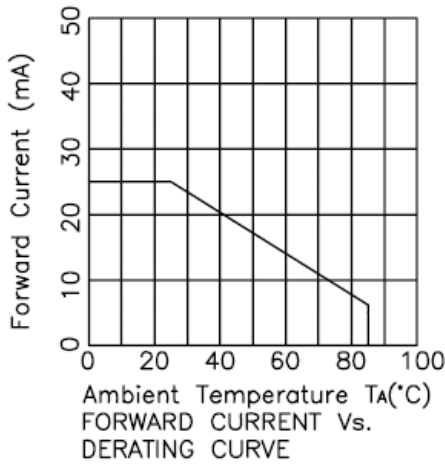
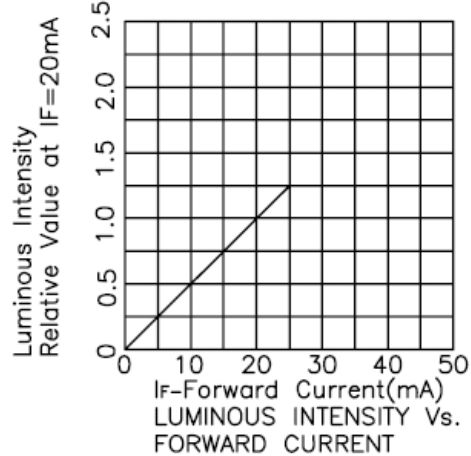
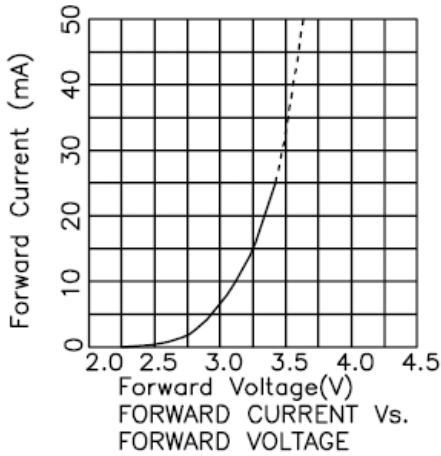
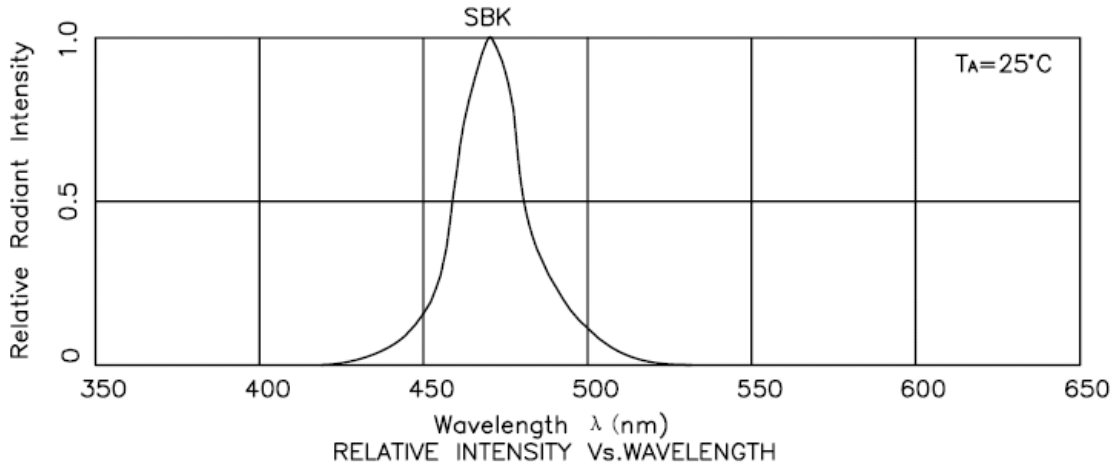



◆ Soldering Profile

Reflow Soldering Profile For Lead-free SMT Process.

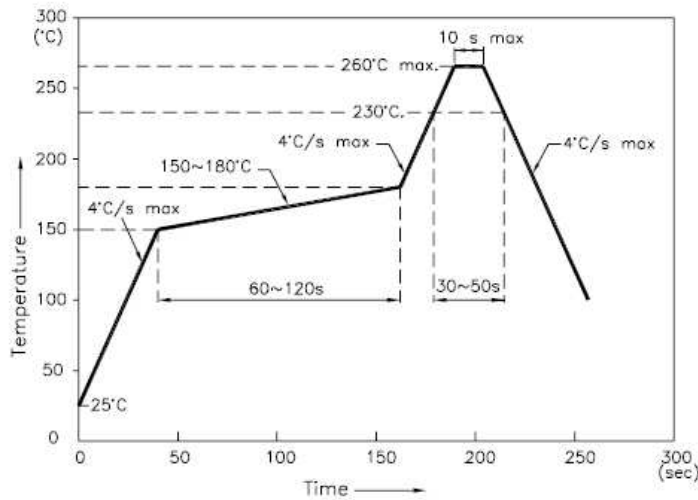

NOTES:

1. We recommend the reflow temperature 245°C (+/-5°C). The maximum soldering temperature should be limited to 260°C.
2. Don't cause stress to the epoxy resin while it is exposed to high temperature.
3. Number of reflow process shall be 2 times or less.

◆ Recommended soldering pattern

(Units:mm)

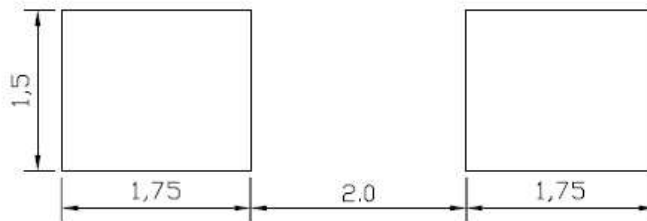

◆ Tape specifications

(Units:mm)

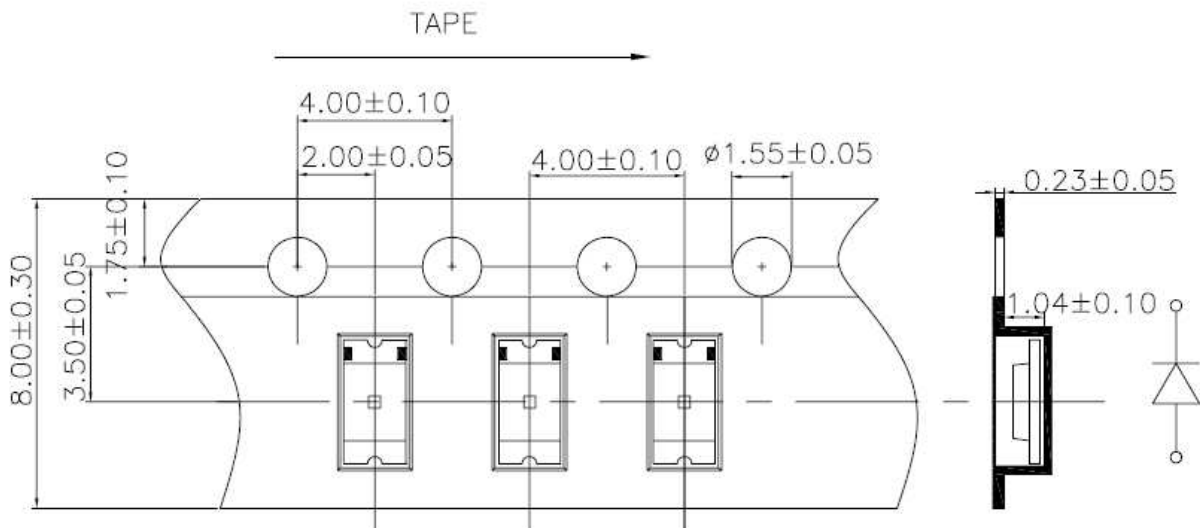



CAUTIONS- SMD LED

Precaution to be taken in designing apparatus using SMD LED:

- (1) The current limiting resistor must be provided in the driving circuit of SMD LED and the circuit should be designed so as to drive SMD LED within the rated value:
Care must be taken to design of the apparatus so that the momentary reverse voltage (or excessive current) is not be charged to SMD LED when the circuit is turned ON or OFF.
- (2) Care must be taken to design the circuit so that the average current is within the rated value of SMD LED if the pulse driving is adapted. And also the circuit should be designed so that the reverse voltage is not charged to SMD LED when the SMD LED is turned off.
- (3) For reflow soldering, the accuracy of SMD LED is within +/- 0.3mm approximately in "X" and "Y" directions. (In case of dip soldering, it is dependent on mounting accuracy.)
- (4) SMD LED is raised by 0 to 0.3mm approximately after soldering.
- (5) In order to avoid the stress in soldered area that may be caused by bending of the circuit board, mounting of SMD LED at a right against longer sided of the circuit board is recommended as illustrated below.
- (6) The pitch between SMD LED should be 3.8 X 9.6mm minimum as illustrated below. .

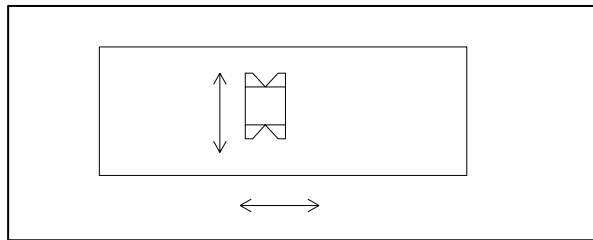

- (7) When assembling the circuit board into the finished products, care must be taken to avoid the component parts from touching other parts.

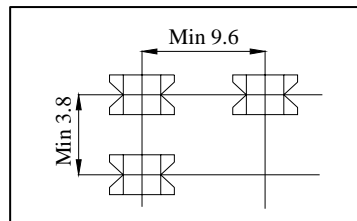

Others

- (1) Care must be taken not to cause stress to the epoxy resin portion of SMD LED while it is exposed to high temperature.
- (2) Care must be taken not to the rub the epoxy resin portion of SMD LED with a hard or sharp edged article such as the sand blast and the metal hook as the epoxy resin is rather soft and liable to be damaged.