



**HESTORE.HU**

elektronikai alkatrész áruház

**EN:** This Datasheet is presented by the manufacturer.

Please visit our website for pricing and availability at [www.hestore.hu](http://www.hestore.hu).

DATE	DESCRIPTION	REV.

FRONT SHELL

INSERTED BODY

REAR SHELL

ASSEMBLED PLUG

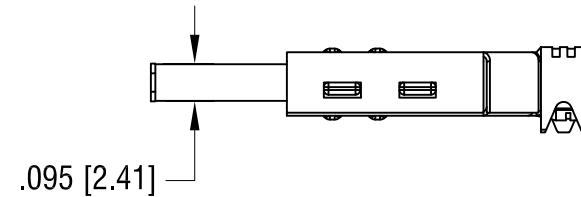
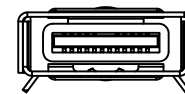
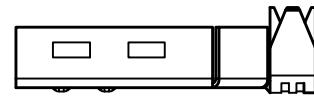
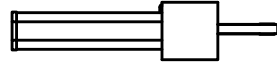
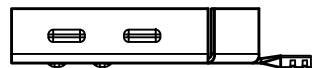
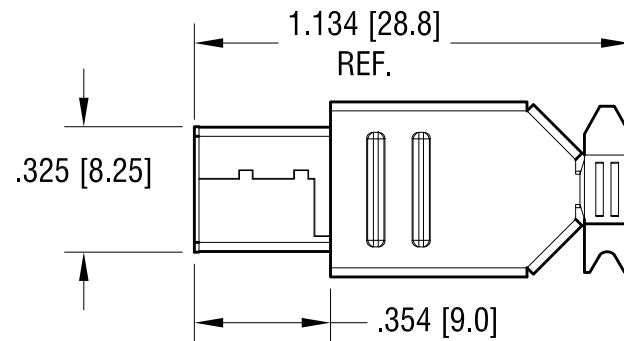
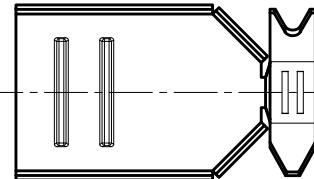
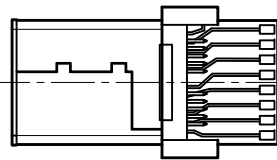
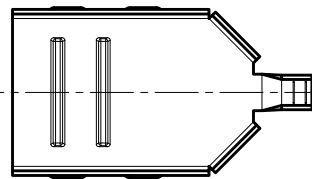
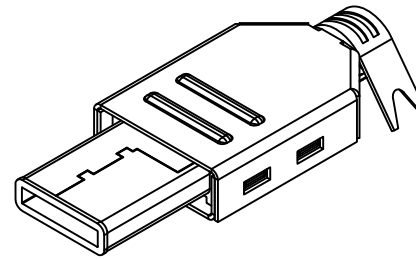
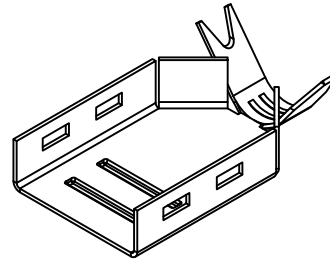
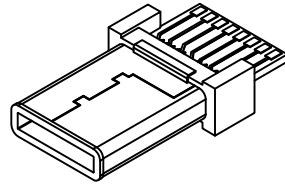
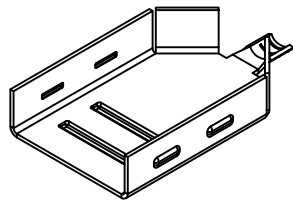

**NOTE:**

- 1. SHELL: METAL, NICKEL PLATED
- 2. CONTACT: MAT'L COPPER, GOLD PLATE
- 3. DIELECTRIC WITHSTANDING VOLTAGE: 1000 VAC FOR 1 MIN.
- 4. OPERATING TEMPERATURE -55°C TO +85°C

- 5. LOW LEVEL CONTACT RESISTANCE:  
 INITIAL: 40mOHMS FOR ALL CONTACT MAX.  
 AFTER: 10mOHMS MAX. CHANGE  
 INSULATION RESISTANCE- 1000 MegoOHMS MIN.  
 DIELECTRIC STRENGTH: 1000 Vac Rms 60Hz. 1Min.

THIS DOCUMENT IS THE PROPERTY OF KEYSTONE ELECTRONICS CORP. AND SHALL NOT BE REPRODUCED, DISTRIBUTED OR USED AS A BASIS FOR MANUFACTURE WITHOUT PRIOR WRITTEN PERMISSION FROM KEYSTONE ELECTRONICS CORP.

<b>KEYSTONE ELECTRONICS CORP.</b>			
www.keyelco.com • ASTORIA, N.Y. 11105-2017 • Tel (718) 956-8900			
PART NAME		USB 3.1 TYPE C PLUG	
MATERIAL		AS NOTED	
FINISH	DRN BY	DATE	
AS NOTED	NT	4.14.15	
	APPD	SCALE	
	LN	3X	
TOLERANCES	INCH	[MM]	CODE
DECIMAL	± .010	[± 0.25]	C
ANGULAR	± 1°		
UNLESS OTHERWISE SPECIFIED			DWG NO.
			<b>954</b>