



HESTORE.HU

elektronikai alkatrész áruház

EN: This Datasheet is presented by the manufacturer.

Please visit our website for pricing and availability at www.hestore.hu.

Specification:

- 1) Rating (if not described next to the switch):
 () 6 A 125 VAC; 3 A 250 VAC
 (A) 10 A 125 VAC; 6 A 250 VAC
- 2) Contact Resistance: 35 mΩ max.
- 3) Insulation Resistance: 500 VDC 100 MΩ min.
- 4) Dielectric strength: 1500 VAC, 1 minute
- 5) Operating temperature: -30°C ~ +80°C
- 6) Electric Life: 10000 cycles

RSSM102A2C7BK/WH

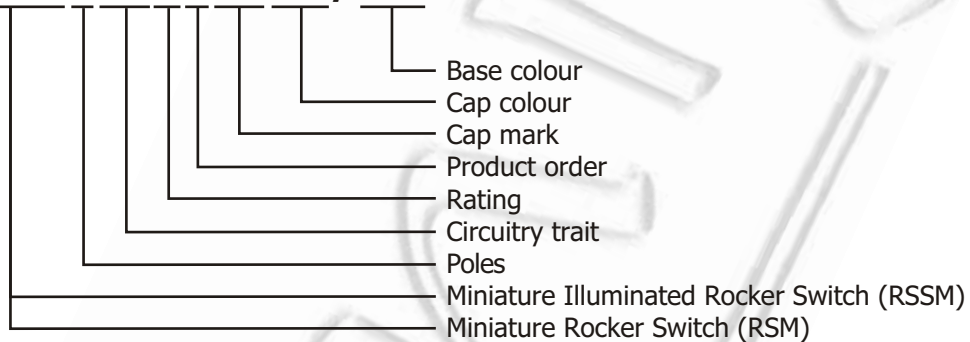

CIRCUITRY TRAIT

01	ON	-	OFF
02	ON	-	ON
11	(ON)	-	OFF
12	ON	-	(ON)
03	ON	OFF	ON
13	ON	OFF	(ON)
23	(ON)	OFF	(ON)

() indicates momentary

CAP COLOUR

RD	red
GN	green
OR	orange
BU	blue
WH	white
BK	black
YL	yellow

BASE COLOUR

WH white
 GY gray
 YL yellow
 omitted when
 standard colour (black)

TERMINAL OPTIONS

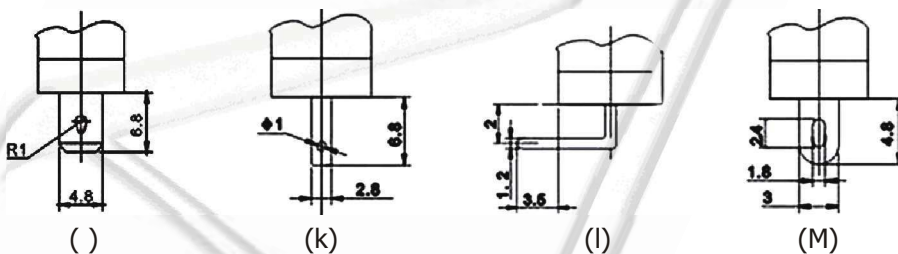

PROTECTIV CAP



RSC-07

CAP MARKING

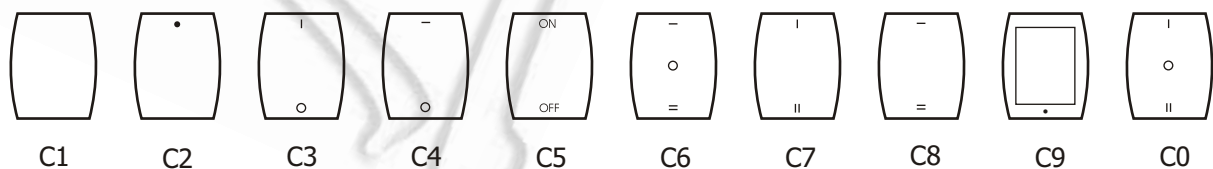

Ninigi



RSM101 ON-OFF
RSM111 (ON)-OFF
RSM101A ON-OFF
RSM111A (ON)-OFF
 SPST 2P

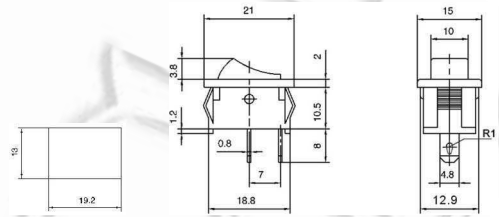

RSM102 RSM102A ON-ON
RSM103 RSM103A ON-OFF-ON
RSM112 RSM112A ON-(ON)
 SPDT 3P

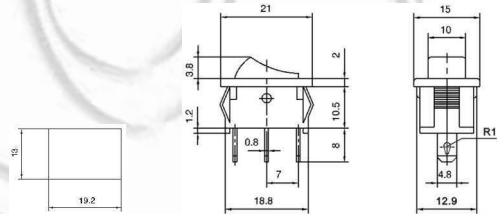

RSSM101 ON-OFF
RSSM101A
 SPST 3P

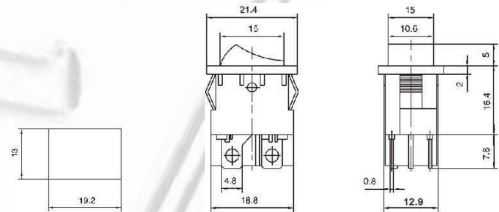

RSSM201 ON-OFF
RSSM201A ON-OFF
RSSM2012 ON-OFF
RSSM201A2 ON-OFF
 DPST 4P

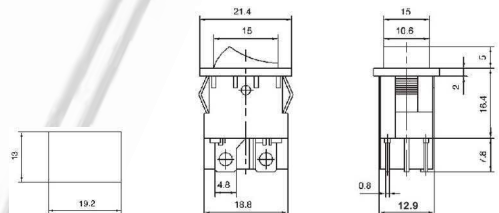

RSM1022 ON-ON
RSM1032 ON-OFF-ON
RSM1132 ON-OFF-(ON)
RSM1232 (ON)-OFF-(ON)
 SPDT 3P

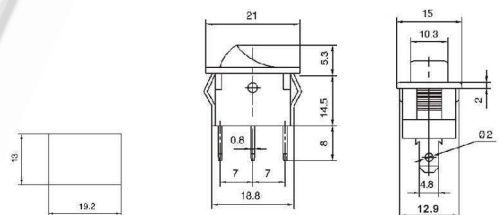

RSM1012 ON-OFF
 10 A 125 VAC; 6 A 250 VAC
 SPST 2P

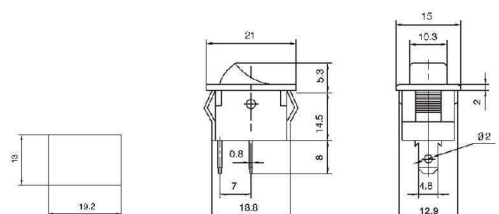

Ninigi



RSM1013 + LED ON-OFF
10 A 125 VAC; 3 A 250 VAC
SPST 4P

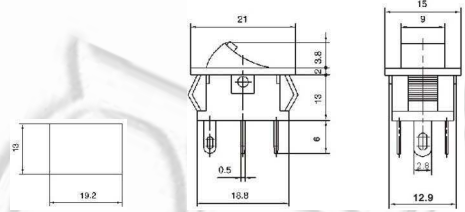

RSM1015 ON-OFF
12 A 125 VAC; 6 A 250 VAC
SPDT 3P

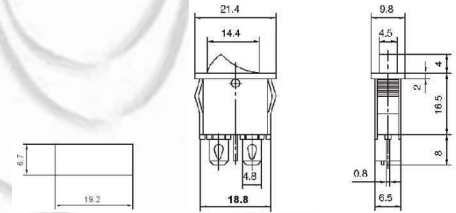

RSM1026 ON-ON
12 A 125 VAC; 6 A 250 VAC
SPDT 3P

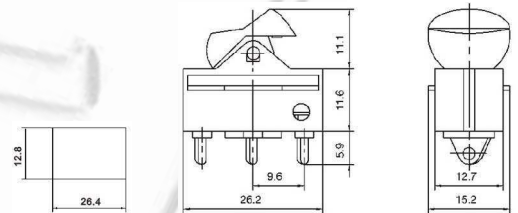

RSM201 ON-OFF
RSM211 (ON)-OFF
RSM201A ON-OFF
RSM211A (ON)-OFF
DPST 4P

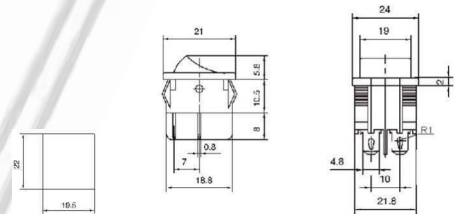

RSM202 ON-ON
RSM203 ON-OFF-ON
RSM202A ON-ON
RSM203A ON-OFF-ON
DPDT 6P

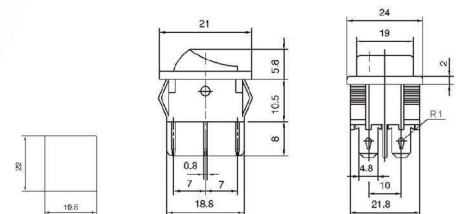

RSM2101 ON-OFF
RSM2111 (ON)-OFF
RSM2101A ON-OFF
RSM2111A (ON)-OFF
DPST 4P

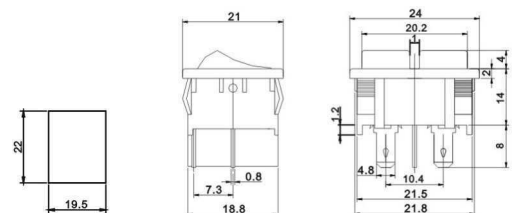

Ninigi



RSM2102 ON-ON
RSM2103 ON-OFF-ON
RSM2102A ON-ON
RSM2103A ON-OFF-ON
 DPDT 6P

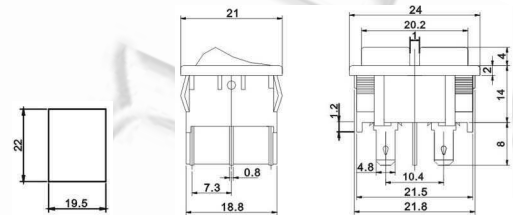

RSSM2101 ON-OFF
 10 A 125 VAC; 6 A 250 VAC
 DPST 6P

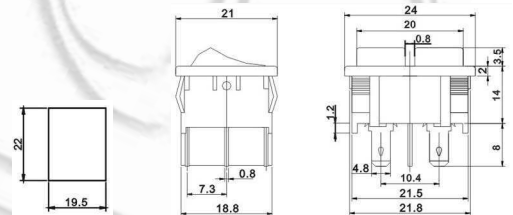

RSSM2101L ON-OFF
 10 A 125 VAC; 6 A 250 VAC
 SPST+LAMP SOCKET

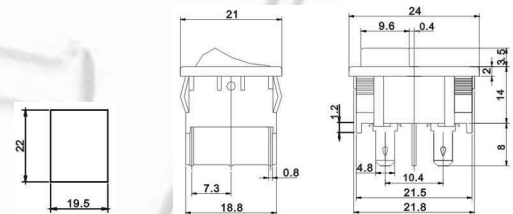

RSM2013 ON-OFF
 10 A 125 VAC; 6 A 250 VAC
 DPST 4P

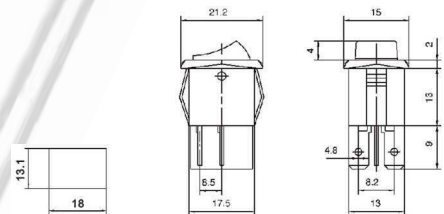

RSM2023 ON-ON
RSM2033 ON-OFF-ON
 6 A 125 VAC; 3 A 250 VAC
 DPDT 6P

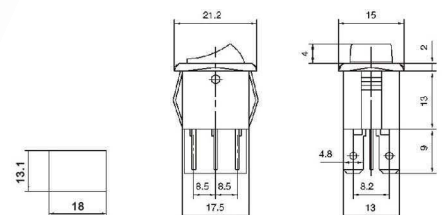

RSSM2014 ON-OFF
RSM2014 ON-OFF
 10 A 125 VAC; 6 A 250 VAC
 DPST 4P

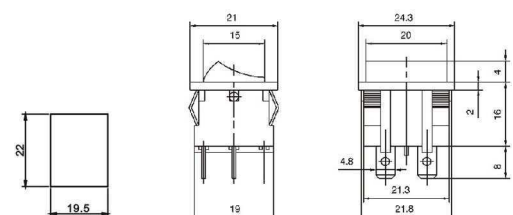

Ninigi



RSM2024 ON-ON
10 A 125 VAC; 6 A 250 VAC
DPDT 6P

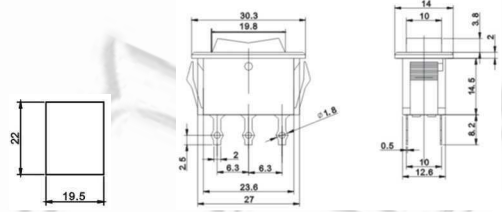

RSSM1018 ON-OFF
12 A 125 VAC; 6 A 250 VAC
SPDT 3P

