



HESTORE.HU

elektronikai alkatrész áruház

EN: This Datasheet is presented by the manufacturer.

Please visit our website for pricing and availability at www.hestore.hu.

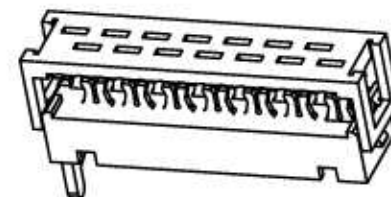
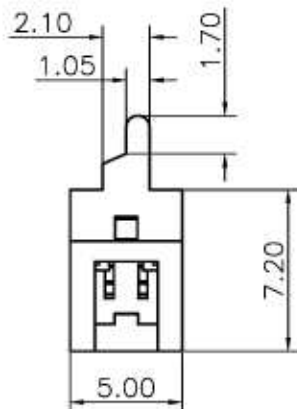
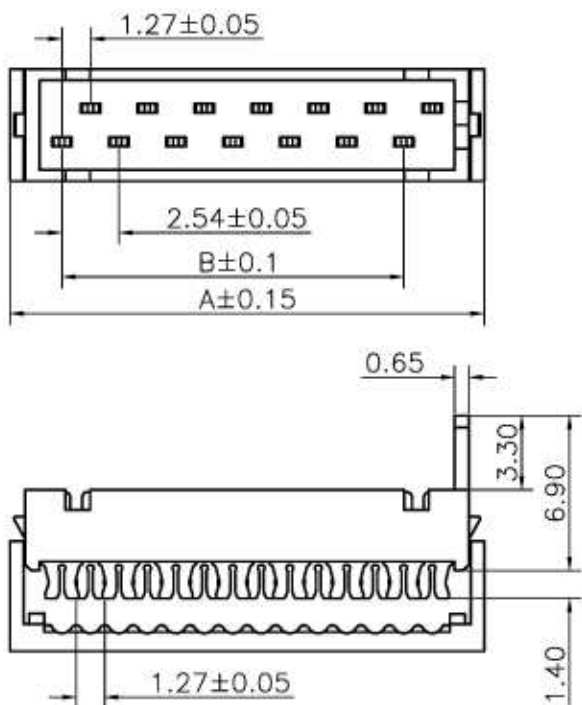

Specifications:

Current Rating:1.0A AC/DC
 Voltage Rating:30V AC/DC
 Contact Resistance:20m ohm. Max.
 Insulation Resistance:1000M ohm. Min.
 Withstanding Voltage:500V AC For One Minute
 Operating Temperature Range:-40°C ~ +105°C
 Material and Finish
 Insulator:High Temp. Plastic (UL94V-0)
 Contact:Copper Alloy
 Finish:Tin Plated

How to Order

TMM-X-X-XX-X

Type
 1-IDC Male
 2-IDC Plug
 3-DIP Male Straight
 4-DIP Female Straight
 5-DIP Female R/A
 6-SMT Female Straight

Locking System
 0-without lock
 L-with lock

Packaging
 1 - Tape & Reel
 2 - Tube
 3 - Bag

Number of Positions
 04, 06, 08, 10, 12,
 14, 16, 18 or 20

Circuits	Dimension		Circuits	Dimension	
	A	B		A	B
4	8.45	2.54	16	23.69	17.78
6	10.99	5.08	18	26.23	20.32
8	13.53	7.62	20	28.77	22.86
10	16.07	10.16	22	31.31	25.40
12	18.61	12.70	24	33.85	27.94
14	21.15	15.24	26	36.39	30.48

TOLERANCE (mm)	APPROVALS	DATE	TITLE	AMPHENOL Amphenol European Design Center	
X, ±0.3	DESIGN: Stephane	2005/04/22	Micro Match IDC type Male	Scale N.A.	Sheet 1 of 1
X.X, ±0.1	CHECKED: Rob K.	2005/04/23			
X.XX, ±0.05	APPROVED: Rob K.	2005/04/23			
UNLESS OTHERWISE SPECIFIED	UNIT:	SIZE: MM	DRAWING N°: A4	TMM-1-0-XX-X	
					REV: A